



# ***INSTRUCTIONS***

# **BONE SAW**

**Model:**

# ***SPM***



## Technical Features

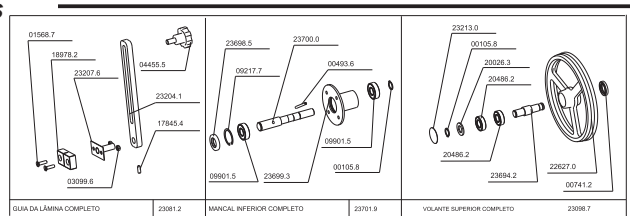
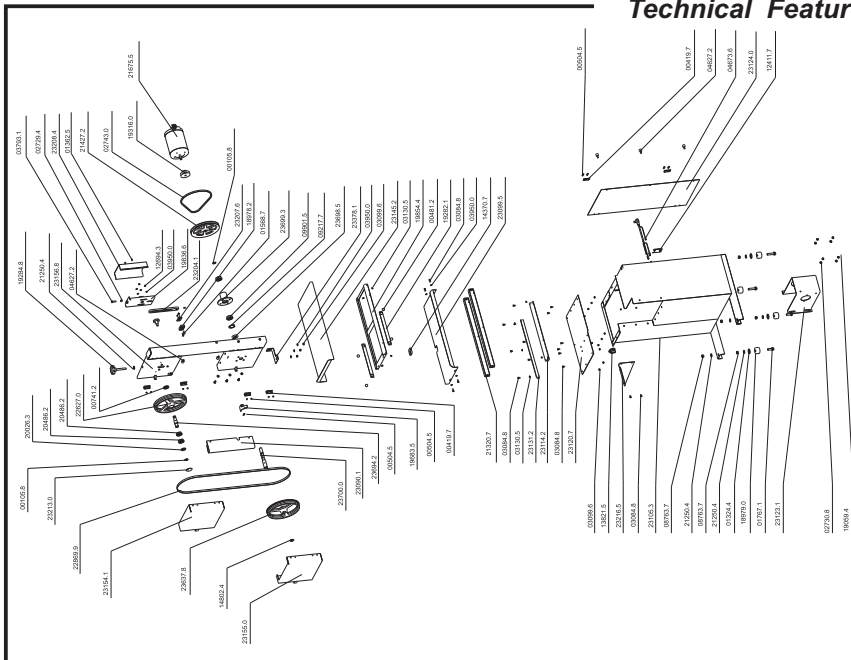

## TECHNICAL DATAS TABLE

Characteristics	Unit	SPM
Voltage	[V]	110 / 220
Frequency	c/s	50 or 60
Power Rating	[hp]	¾
Height	[mm]	1590
Width	[mm]	780
Depth	[mm]	700
Net weight	[kg]	66
Gross weight	[kg]	90
Consumption	[Kw.h]	0,552
Blade length	[mm]	2,18
Max. cutting measures	[mm]	355x250

\* Only one frequency is allowed , being the rated motor frequency .

Exploded Drawing

## Spare Parts

CODIGO	DESCRICAO DO COMPONENTE	UM	CODIGO	DESCRICAO DO COMPONENTE	UM
00105-8	ANEL 20x1,2 DIN 471	CE	19683-5	RASPADOR SP/SPL	PC
00419-7	DOBRADICA 2" ZINC.	PC	19836-6	CS ESTICADOR DA LAMINA	PC
00481-2	ESFERA 3/4" ACO 19.05	PC	19854-4	CS TRILHO SUPERIOR	PC
00493-6	PINO ELAST.6x70 DIN 1481	CE	20026-3	ARR.L.A21x2mm ZB	CE
00504-5	REBITE PRESSAO AD-650-S	MI	20486-2	ROLAMENTO 6004 DDU	PC
00741-2	RETENTOR 01604BR* (F.126)	PC	21260-4	ARR.L.A13 DIN 125 ZB	CE
01323-4	ARR.L.A21 DIN 125 ZB	CE	21427-2	POLIA MOVIDA DIAM. 250mm	PC
01362-5	PFS M4x10 DIN 933 ZB	CE	21675-5	MOTOR 0,75CV 60HZ	PC
01568-7	PFS M6x20 DIN 963 ZB	CE	22627-0	VOLANTE SUPDIAM.260 SPM	PC
01767-1	PFS M12x50 DIN 933 ZB	CE	22637-8	VOLANTE INF.DIAM.260 SPM	PC
02729-4	PCA M8 DIN 934 ZB	CE	22869-9	LAMINA MK1/2"x6SKA6-2180	PC
02730-8	ARR.L.A8,4 DIN 125 ZB	CE	23081-2	CONJ.GUIA DA LAMINA SPM	PC
02743-0	CORREIA A 34	PC	23090-1	PROTECAO DA LAMINA	PC
03084-8	PFS M6x12 DIN 933 ZB	CE	23098-7	VOLANTE SUPER. COMPL. SPM	PC
03099-6	PCA M6 DIN 934 ZB	CE	23099-5	CS MESA FIXA	PC
03130-5	PFS M4x8 DIN 84 ZB	CE	23105-3	CS GABINETE DO MANCAL	PC
03793-1	PFS M8x30 DIN 933 ZB	CE	23114-2	TRILHO INFERIOR DIREITO	PC
03950-0	ARR.L.A6,4 DIN 125 ZB	CE	23120-7	SUPOORTE DOS TRILHOS	PC
04455-5	MANIPULO C/HASTE 3/8"x20	PC	23123-1	SUPOORTE DO MOTOR	PC
04627-2	MANIP.RECART.M6x15mm-CRW	PC	23124-0	TAMPA GABINETE INFERIOR	PC
04673-6	CB.3x0,75mm2C/PG90S2PR1FT	PC	23131-2	TRILHO INFERIOR ESQUERDO	PC
08763-7	PCA M12 DIN 934 ZB	CE	23145-2	CS MESA MOVEL SPM	PC
09217-7	ANEL 47x1,75 DIN 472	CE	23154-1	CS PORTA SUPERIOR	PC
09901-5	ROLAMENTO 6204 DDU	PC	23155-0	CS PORTA INFERIOR	PC
12394-3	PCA N M6 DIN 985 ZB	CE	23156-8	CS COLUNA/CABECOTE SPM	PC
12411-7	CHAVE SELETORA COMPLETA	PC	23204-1	SUPOORTE GUIA LAMINA SPM	PC
13821-5	CHAVE TECL.30223 M2FT2E3Q	PC	23207-6	CS SUPOORTE DO TACO SPM	PC
14370-7	TACO DA MESA SKG/SKGL	PC	23208-4	TAMPA DO ESTICADOR SPM	PC
14802-4	ANEL 25x1,2 DIN 471	CE	23213-0	TAMPA DO VOLANTE SPM	PC
17845-4	PFS M6x12 DIN 918 FOSF.	PC	23216-5	REFORCO DA MESA SPM	PC
18978-2	TACO GUIA DA LAMINA	PC	23378-1	REFORCO DO MOTOR SPM	PC
18979-0	PE DE BORRACHA	PC	23694-2	EIXO SUPERIOR	PC
19059-4	PFS M8x16 DIN 933 ZB	CE	23698-5	RETENTOR 5506 BRG	PC
19282-1	DISTANCIADOR DE ESFERAS	PC	23699-3	MANCAL INFERIOR	PC
19284-8	MANIPULO C/HASTE M12x85mm	PC	23700-0	EIXO INFERIOR	PC
19316-0	POLIA MOTORA SP/SPL	PC	23701-9	MANCAL INFERIOR COMPLETO	PC

## User Instrutions

- 1 Read the Technical Data Table
- 2 The saw selected voltage shall be the same as the power source voltage.
- 3 Never clean or make maintenance with the machine plugged on the electric network .
- 4 Never touch the saw with wet hands, shoes or clothes .
- 5 Never introduce into the saw any products, or objects that could not be cut by their size or nature.
- 6 Do not throw water jets directly on the saw .
- 7 To tighten the motor belt, tight the screw M12x50mm on the side of the bearing enclosure, using a spanner No. 19 .

Operation :

A ) place the meat piece upon the movable table.

B ) Switch ON the saw.

C ) Push the meat towards the blade .

Observation : Be very careful when pushing the Meat . Never let your hands on a direct path towards the blade .For your own safety use steel gloves .

### SAFETY PRECAUTIONS

The safety precautions were prepared to properly instruct the operators and the maintenance team . The machine shall only be given to the operators in good working conditions and they shall be properly oriented about how to use it safely , by the Dealer . The operator shall use the machine only after a complete knowledge of the cares to be taken when operating the machine , by carefully reading the instruction manual .

### BASIC OPERATION PROCEDURES

1. **Dangers**  
Some parts of the machine electrical commands have high voltage points or terminals . These when touched , may produce high shocks , and even death . Never touch a manual command ( button, electric switch , etc. ) with wet hands , shoes or clothes . If this warning is not understood electric shocks and even death may occur.
2. **Warnings**  
The Switch ON/OFF position must be well known , to allow it to be used without to look for it . Before to proceed to any maintenance , unplug the machine from the electric network . Provide enough space around the machine to avoid falls . Water and oil may produce a dangerous and slippery floor . To avoid accidents the floor shall be dry and clean . Before to use any manual command ( button , switch , lever , etc ) be sure the command is the correct one . In case of doubt consult the Instruction Manual . Never use a manual command unadvisedly . If any work has to be done by more than one person , coordination signs shall be accorded , for each step of the work . Next step shall not be started without the sign is given and acknowledged .

3. **ADVICES**  
If an electric supply failure happens , the machine shall immediately be switched OFF . Use recommended or similar lubricating oils or greases . Avoid any strikes on the machine , since they could produce failures or a bad performance . DO NOT CHANGE the machine original characteristics . DO NOT TEAR , WITHDRAW OR GET DIRTY ANY WARNING LABEL , if the label is lost or unreadable ask for a new one to your Dealer .

READ CAREFULLY THE SAFETY LABELS ON THE MACHINE , THE INSTRUCTION MANUAL AND THE TECHNICAL CHARACTERISTICS ,WRITTEN ON THE MACHINE DOCUMENTATION

### CHEKINGS AND CARES BEFORE TO START THE MACHINE IMPORTANT

- 1 **Danger**  
Read carefully the INSTRUCTION MANUAL before to start the machine . Be sure all the instructions have been understood . Any doubt consult the Department Chief or the nearest Dealer .
- 2 **Warning**  
Electric wires must have a perfect insulation, any damage may cause electric shock . Before to use them be sure they are in good conditions .
- 3 **Cares**  
Be assured the operating instructions have been correctly understood . Each function and operation or maintenance procedure shall be perfectly clear . Any manual command ( button , lever , switch , etc ) shall be only given after to be sure it is the right desired command .
4. **Advices**  
Long hairs that could touch the machine , could cause serious accidents . Tie them behind the head or cover them with a scarf . Only skilled operators shall use the machine .

### ROUTINE INSPECTION

The electric cord , used to feed electricity to the machine has to have the right section to support the machine motor power rating . Any electric wiring running over the floor near the machine shall be duly protected to avoid short circuits .

Carefully listen to any abnormal noises coming from the motor or any moving parts .